

ARTICULO: 2025

Válvula de esfera paso total 3 piezas Inoxidable. Stainless steel full port ball valve, 3 piece.

Características

1. Válvula esfera paso total 3 piezas
2. Extremos roscados DIN 2999 Std.
3. Construcción en Inox AISI 316 (CF8M) .
4. Asientos PTFE + 15 % Fibra de Vidrio.
5. Tórica en el eje de Viton.
6. Juntas del eje PTFE + 15 % Grafito.
7. Sistema de bloqueo.
8. Montaje actuador directo s/ ISO 5211 (sistema patentado 9900474).
9. Eje inexpulsable.
10. Presión de trabajo máxima 63 Kg/cm2.
11. Temperatura de trabajo -25 °C + 180 °C.

Features

1. Stainless steel full port ball valve, 3 piece.
2. Thread ends according to DIN 2999 standard.
3. Made of AISI 316 (CF8M).
4. Ball seats PTFE + 15 % G.F.
5. Viton o'ring stem.
6. Stem gasket PTFE + 15 % Graphite.
7. Locking system.
8. Direct mounting actuator ISO 5211 (patent system 9900474).
9. Blow-out proof stem.
10. Max.. Working pressure 63 Kg/cm2.
11. Working Temperature -25 °C + 180 °C.

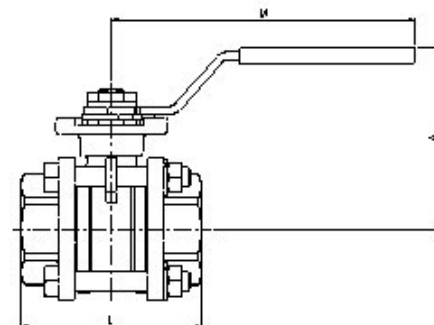
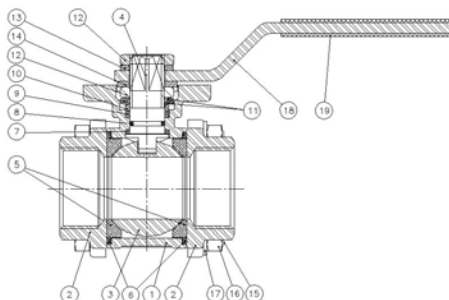

| Nº | Denominación/Name | Material | Acabado Superficial/Surface Treatment |
|----|----------------------------------|-------------------------------------|---------------------------------------|
| 1 | Cuerpo / Body | Acero Inox AISI 316 / SS 316 | Granallado / Shot blasting |
| 2 | Tapa / Cap | Acero Inox AISI 316 / SS 316 | Granallado / Shot blasting |
| 3 | Bola / Ball | Acero Inox AISI 316 / SS 316 | ----- |
| 4 | Eje / Stem | Acero Inox AISI 316 / SS 316 | ----- |
| 5 | Asiento / Seat ball | Teflón + 15% FV / PTFE + 15% GF. | ----- |
| 6 | Junta / Gasket | Teflón + grafito / PTFE + graphite. | ----- |
| 7 | Arandela / Trust Washer | Teflón + grafito / PTFE + graphite. | ----- |
| 8 | Tórica / O'ring | Viton | ----- |
| 9 | Anillo Prensa / Stem packing | PTFE | ----- |
| 10 | Anillo Prensa / Stem ring | Acero Inox AISI 316 / SS 316 | ----- |
| 11 | Arandela Resorte / Spring Washer | Acero Inox AISI 301 / SS 301 | ----- |
| 12 | Tuerca / Nut | Acero Inox AISI 304 / SS 304 | ----- |
| 13 | Arandela / Washer | Acero Inox AISI 304 / SS 304 | ----- |
| 14 | Antigiro / Stopper | Acero Inox AISI 304 / SS 304 | ----- |
| 15 | Tornillo / Bolt | Acero Inox AISI 304 / SS 304 | ----- |
| 16 | Tuerca / Nut | Acero Inox AISI 304 / SS 304 | ----- |

| Nº | Denominación/Name | Material | Acabado Superficial/Surface Treatment |
|----|-------------------------------|------------------------------|---------------------------------------|
| 17 | Arandela muelle / Bolt washer | Acero Inox AISI 304 / SS 304 | ----- |
| 18 | Maneta / Handle | Acero Inox AISI 304 / SS 304 | ----- |
| 19 | Funda / Handle Sleeve | Vynil | ----- |

Únicamente en medidas de 2 1/2" – 4" / For 2 1/2" – 4" Sizes Only.

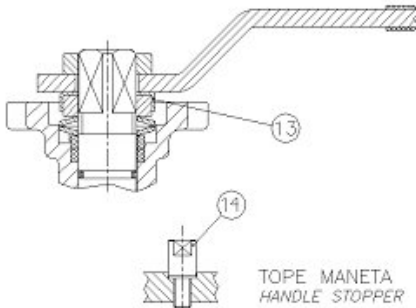

| Nº | Denominación/Name | Material | Acabado Superficial/Surface Treatment |
|----|------------------------|------------------------------|---------------------------------------|
| 13 | Antigiro / Lock Washer | Acero Inox AISI 304 / SS 304 | ---- |
| 14 | Tope / Stopper | Acero Inox AISI 304 / SS 304 | ---- |

DIMENSIONES GENERALES / GENERAL DIMENSIONS

| Ref | Medida/Size | PN | Paso | Dimensiones/Dimensions (mm) | | | | Peso/Weight (Kg) |
|---------|-------------|----|------|-----------------------------|------|-----|-----------|------------------|
| | | | | A | L | M | ISO 5211 | |
| 2025 02 | 1/4" | 63 | 11 | 60 | 49.6 | 112 | F-03 | 0.39 |
| 2025 03 | 3/8" | 63 | 12.7 | 60 | 49.6 | 112 | F-03 | 0.38 |
| 2025 04 | 1/2" | 63 | 15 | 60 | 56 | 112 | F-04 | 0.44 |
| 2025 05 | 3/4" | 63 | 20 | 70 | 73 | 138 | F-04/F-05 | 0.82 |
| 2025 06 | 1" | 63 | 25 | 70 | 82 | 138 | F-04/F-05 | 1.02 |
| 2025 07 | 1 1/4" | 63 | 32 | 88 | 91 | 160 | F-05/F-07 | 1.79 |
| 2025 08 | 1 1/2" | 63 | 40 | 94 | 104 | 205 | F-05/F-07 | 2.46 |
| 2025 09 | 2" | 63 | 50 | 100 | 120 | 205 | F-05/F-07 | 3.47 |
| 2025 10 | 2 1/2" | 63 | 65 | 150 | 155 | 330 | F-07/F-10 | 8.50 |
| 2025 11 | 3" | 63 | 80 | 165 | 182 | 330 | F-07/F-10 | 12.40 |
| 2025 12 | 4" | 63 | 100 | 175 | 220 | 340 | F-07/F-10 | 19.65 |

CURVA PRESION TEMPERATURA / PRESSURE TEMPERATURE RATING

